



CHAIN & ACCESSORIES

A-1338



- Forged alloy steel — Quenched & Tempered.
- Innovative cradle design allows for 100% efficiency of Grade 100 chain.
- Individually Proof Tested to 2-1/2 times the Working Load Limit with certification.
- Each hook has a Product Identification Code (PIC) for material traceability, along with the size and the name Crosby.
- Suitable for use with Grade 100 and Grade 80 chain.
- The use of A-1338 Cradle Grab Hook will allow 100 percent of the chain sling capacity. When used to hook back to chain leg to form a choker, the angle of the choke must be 120 degrees or greater. When used as a chain shortener, minimize twist of chain and ensure chain is fully engaged in hook.
- Fatigue rated to 20,000 cycles at 1-1/2 times the Working Load Limit.

L-1338

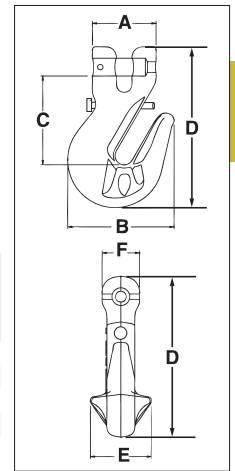
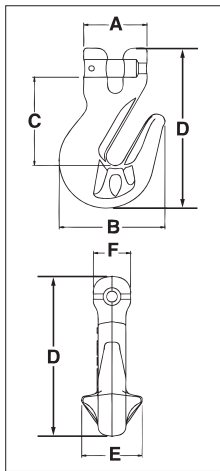

6



A/L-1338 Cradle Grab Hook

Chain Size (in) (mm)	Working Load Limit (t)	A-1338 Stock No.	L-1338 Stock No.	Weight Each (kg)	Dimensions (mm)						S-4338 Replacement Latch Kit Stock No.
					A	B	C	D	E	F	
1/4 7	2.0	1049417	1049480	.20	43.7	64.5	55.9	98.5	38.1	22.4	1048426
5/16 8	2.6	1049426	1049489	.45	43.7	64.5	55.4	98.5	38.1	22.4	1048426
3/8 10	4.0	1049435	1049498	.82	47.0	78.5	65.5	119	46.5	27.7	1048435
1/2 13	6.8	1049444	1049507	1.78	60.7	97.3	83.3	149	57.2	36.1	1048444
5/8 16	10.3	1049453	1049516	3.18	67.8	115	97.8	179	74.5	44.5	1048453

4:1 Design Factor.

A-1358

APPLICATION AND WARNING INFORMATION SECTION 17



- Forged alloy steel — Quenched & Tempered.
- Individually Proof Tested to 2-1/2 times the Working Load Limit with certification.
- Each hook has a Product Identification Code (PIC) for material traceability, along with the size and the name Crosby.
- Suitable for use with Grade 100 and Grade 80 chain.
- Fatigue rated to 20,000 cycles at 1-1/2 times the Working Load Limit.

L-1358

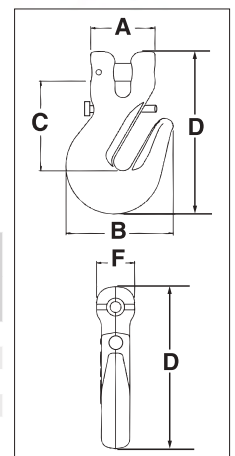
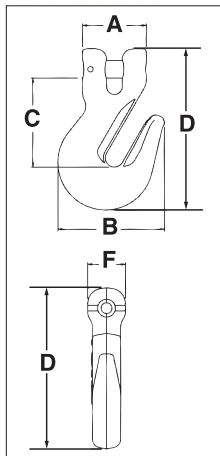

A/L-1358 Grab Hook

Chain Size (in) (mm)	Working Load Limit (t)	A-1358 Stock No.	L-1358 Stock No.	Weight Each (kg)	Dimensions (mm)					S-4338 Replacement Latch Kit Stock No.
					A	B	C	D	F	
1/4 7	2.0	1049610	1049605	.20	43.7	64.5	55.9	98.5	22.4	1048426
5/16 8	2.6	1049629	1049614	.45	43.7	64.5	55.4	98.5	22.4	1048426
3/8 10	4.0	1049638	1049623	.82	47.0	78.5	65.5	119	27.7	1048435
1/2 13	6.8	1049647	1049634	1.78	60.7	97.3	83.3	149	36.1	1048444
5/8 16	10.3	1049656	1049643	3.18	67.8	115	97.8	179	44.5	1048453

4:1 Design Factor.



A-1370



- Forged alloy steel — Quenched & Tempered.
- Individually proof tested to 2.5 times the Working Load Limit.
- Proof test certification shipped with each link.
- Each link has a Product Identification Code (PIC) for material traceability, along with the size and the name Crosby in raised letters.
- Suitable for use with Grade 100 and Grade 80 chain.

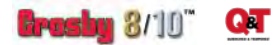
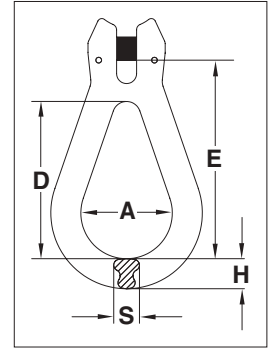

A-1370 Reeving Link

Chain Size		Working Load Limit (t)	Stock No.	Weight Each (kg)	Dimensions (mm)				
(in)	(mm)				A	D	E	H	S
1/4-5/16	7-8	2.5	1012000	0.26	39.0	67.5	90.0	16.0	10.0
3/8	10	4.0	1012009	0.50	49.0	85.5	108	17.0	14.0
1/2	13	6.8	1012018	1.10	62.5	108	138	21.0	18.0
5/8	16	10.3	1012027	2.55	79.0	139	180	30.5	25.5

4:1 Design Factor.

L-1339



- Forged alloy steel — Quenched & Tempered.
- Individually Proof Tested to 2-1/2 times the Working Load Limit with certification.
- Each hook has a Product Identification Code (PIC) for material traceability, along with the size and the name Crosby.
- Hoist hooks incorporate QUIC-CHECK® deformation and angle indicators.
- Low profile hook tip.
- New integrated latch (S-4320/S-4339) meets the world standard for lifting.
 - Heavy duty stamped latch interlocks with the hook tip.
 - High cycle, long life spring.
 - When secured with the proper cotter pin through the hole in the tip of hook, meets the intent of OSHA Rule 1926.1431(g) and 1926.1501(g) for personnel lifting.
- Suitable for use with Grade 100 and Grade 80 chain.
- Fatigue rated at 1-1/2 times the Working Load Limit at 20,000 cycles.

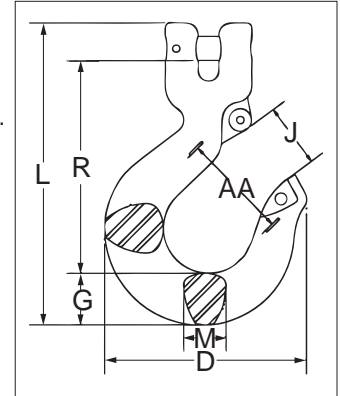

L-1339 Clevis Sling Hook

Chain Size		Working Load Limit (t)	Hook ID Code	Stock No.	Weight Each (kg)	Dimensions (mm)							S-4320 Repl. Latch Stock No.	S-4339 Repl. Latch Stock No.
(in)	(mm)					D	G	J	L	M	R	AA		
-	6	1.5	DA	1049103	0.29	72.6	18.5	23.6	107	16.0	74.9	38.1	1096325	-
1/4	7	2.0	HA	1049112	0.72	98.0	26.4	30.2	144	19.1	101	50.8	1096468	-
5/16	8	2.6	HA	1049121	0.71	98.0	26.4	30.2	144	19.1	100	50.8	1096468	-
3/8	10	4.0	IA	1049130	1.17	111	30.2	38.9	171	25.4	120	63.5	1096515	-
1/2	13	6.8	JA	1049149	2.39	142	36.6	45.2	213	29.7	150	76.2	1096562	-
5/8	16	10.3	KA	1049158	4.45	172	48.0	61.2	259	36.6	177	102	1096609	-
3/4	18-20	16.0	KHX19	1049167	8.30	211	71.9	68.3	332	50.0	203	114	-	1048714
7/8*	22-23*	21.0	KHX23	1049176	11.2	233	78.0	77.5	355	50.0	223	127	-	1048732

4:1 Design Factor.

*7/8 in (22-23 mm) size does not have cam, latch attaches to unique pin.

CHAIN & ACCESSORIES



CHAIN & ACCESSORIES

A-1359



- Forged alloy steel — Quenched & Tempered.
- Individually Proof Tested to 2-1/2 times the Working Load Limit with certification.
- Each hook has a Product Identification Code (PIC) for material traceability, along with the size and the name Crosby.
- Suitable for use with Grade 100 and Grade 80 chain.
- Fatigue rated to 20,000 cycles at 1-1/2 times the Working Load Limit.
- Hook can be tip loaded at the reduced Working Load Limit, see below.
- Operator must ensure the load is retained properly in the hook.

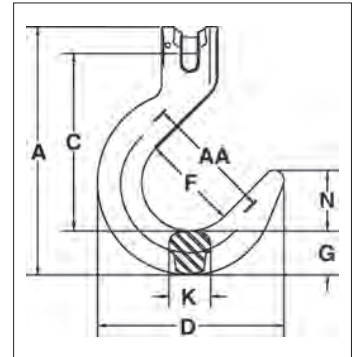

A-1359 Clevis Foundry Hook

Chain Size		Stock No.	Working Load Limit at Saddle of Hook (t)	Working Load Limit at Tip of Hook (t)	Weight Each (kg)	Dimensions (mm)								Deformation Indicators AA
(in)	(mm)					A	C	D	F	G	K	N	T	
1/4	7	1049907	2.0	1.0	0.98	159.0	111.3	122.4	63.5	28.7	22.4	39.9	88.9	
5/16	8	1049911	2.6	1.3	0.93	159.0	111.0	122.4	63.5	28.7	22.4	39.9	88.9	
3/8	10	1049916	4.0	2.0	1.95	197.1	140.7	147.8	76.2	35.1	33.0	47.8	101.6	
1/2	13	1049925	6.8	3.4	3.62	238.3	169.4	178.8	88.9	41.4	38.1	57.2	114.3	
5/8	16	1049934	10.3	5.1	6.44	285.8	195.1	207.5	101.6	55.6	44.5	64.3	127.0	
3/4	18-20	1049943	16.0	8.0	11.2	366.5	248.7	245.1	127.0	61.0	55.9	86.1	152.4	
7/8	22-23	1049952	21.0	10.0	19.9	412.8	279.9	280.2	139.7	78.0	69.1	95.0	165.1	

4:1 Design Factor.

6



A-1329



- Forged alloy steel — Quenched & Tempered.
- Individually Proof Tested to 2-1/2 times the Working Load Limit with certification.
- Each hook has a Product Identification Code (PIC) for material traceability, along with the size and the name Crosby.
- Suitable for use with Grade 100 and Grade 80 chain.
- Fatigue rated to 20,000 cycles at 1-1/2 times the Working Load Limit.
- Hook can be tip loaded at the reduced Working Load Limit, see below.
- Operator must ensure the load is retained properly in the hook.

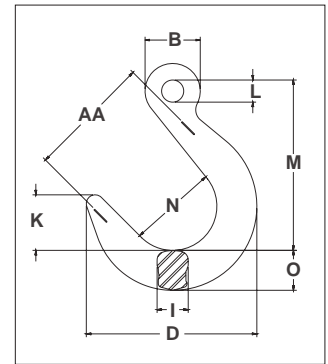

A-1329 Eye Foundry Hook

Chain Size		Stock No.	Working Load Limit at Saddle of Hook (t)	Working Load Limit at Tip of Hook (t)	Weight Each (kg)	Dimensions (mm)								Deformation Indicators AA
(in)	(mm)					B	D	I	K	L	M	N	O	
1/4 - 5/16	7-8	1026280	2.6	1.3	.91	39.6	122.4	22.4	39.9	16.0	122.2	63.5	28.7	89
3/8	10	1026289	4.0	2.0	1.72	52.6	147.8	33.0	47.8	20.6	139.7	76.2	35.1	102
1/2	13	1026297	6.8	3.4	3.27	64.3	178.8	38.1	57.2	26.2	180.6	88.9	41.4	114
5/8	16	1026306	10.3	5.1	5.58	76.2	207.5	44.5	64.3	31.8	202.2	101.6	55.6	127
3/4	18-20	1026315	16.0	8.0	10.4	104.9	245.1	55.9	86.1	50.0	273.1	127.0	61.0	165
7/8	22-23	1026324	21.0	10.0	18.4	121.2	280.2	69.1	95.0	57.9	311.2	139.7	78.0	178
1	26	1026333	27.1	13.5	23.5	135.4	302.3	71.9	99.8	65.0	339.6	152.4	84.1	191
1 1/4	32	1026342	41.0	20.5	38.3	167.9	336.6	88.9	110.0	80.0	387.4	165.1	97.5	203

4:1 Design Factor.



A-1328



- Forged alloy steel — Quenched & Tempered.
- Individually Proof Tested to 2-1/2 times the Working Load Limit with certification.
- Each hook has a Product Identification Code (PIC) for material traceability, along with the size and the name Crosby.
- Suitable for use with Grade 100 and Grade 80 chain.
- Fatigue rated at 1-1/2 times the Working Load Limit at 20,000 cycles.

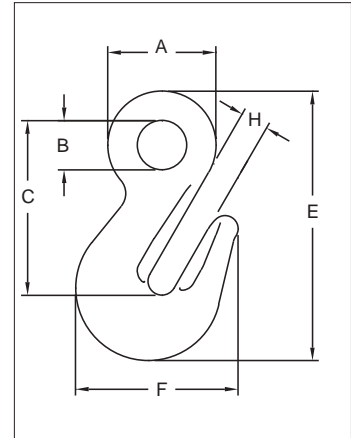

A-1328 Eye Grab Hook

Chain Size		Working Load Limit (t)	Stock No.	Weight Each (kg)	Dimensions (mm)					
(in)	(mm)				A	B	C	E	F	H
1/4 - 5/16	7 - 8	2.6	1026169	.44	44.5	19.1	70.9	109	66.3	11.2
3/8	10	4	1026187	.73	52.3	23.9	84.6	130	78.5	13.5
1/2	13	6.8	1026196	1.50	65.0	28.4	104	162	97.3	16.8
5/8	16	10.3	1026205	2.72	78.0	33.3	125	194	115	20.0
3/4	19-20	16	1026214	4.54	82.6	38.1	137	223	152	23.9
7/8	22-23	20	1026223	5.94	100	46.0	165	257	166	27.7
1	26	27.1	1026232	8.57	113	50.8	183	291	197	30.2
1 1/4	32	41	1026241	17.9	143	60.5	231	371	241	38.1

4:1 Design Factor.

A-1348



- Forged alloy steel — Quenched & Tempered.
- The use of A-1348 Cradle Grab Hook will allow 100% percent of the chain sling capacity. When used to hook back to chain leg to form a choker, the angle of the choke must be 120 degrees or greater. When used as a chain shortener, minimize twist of chain and ensure chain is fully engaged in hook.
- Innovative cradle design allows for 100% efficiency of Grade 100 chain.
- Individually Proof Tested to 2-1/2 times the Working Load Limit with certification.
- Each hook has a Product Identification Code (PIC) for material traceability, along with the size and the name Crosby in raised letters.
- Suitable for use with Grade 100 and Grade 80 chain.
- Fatigue rated to 20,000 cycles at 1-1/2 times the Working Load Limit.

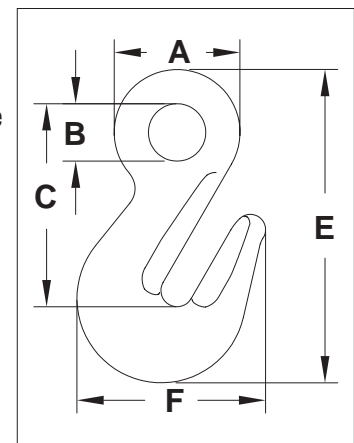

A-1348 Eye Cradle Grab Hook

Chain Size		Working Load Limit (t)	Stock No.	Weight Each (kg)	Dimensions (mm)				
(in)	(mm)				A	B	C	E	F
1/4-5/16	7-8	2.5	1026200	0.35	36.3	16.5	64.0	98.2	58.2
3/8	10	4.0	1026209	0.64	49.5	26.0	78.0	120	68.8
1/2	13	6.8	1026218	0.87	62.0	29.0	97.0	146	82.4
5/8	16	10.3	1026227	2.83	79.0	36.0	126.5	196	111.8

4:1 Design Factor.



CHAIN & ACCESSORIES



- Latch Kits shipped unassembled and individually packaged with instructions.
- For use only with Crosby L-1338 and L-1358 Grab Hooks.

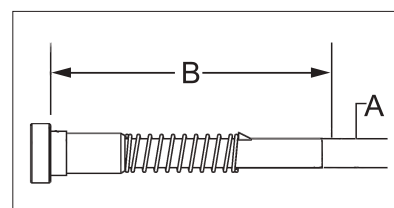

S-4338 Grab Hook Latch Kits

Hook Size		Stock No.	Weight Each (kg)	Dimensions (mm)	
(in)	(mm)			A	B
1/4	7	1048426	.01	4.7	40.4
5/16	8	1048435	.01	4.7	45.2
3/8	10	1048444	.02	6.3	57.2
1/2	13	1048453	.03	7.9	65.2

APPLICATION AND WARNING INFORMATION SECTION 17

6



- Forged alloy steel — Quenched & Tempered.
- Individually Proof Tested to 2-1/2 times the Working Load Limit with certification.
- Recessed trigger design is flush with the hook body, protecting the trigger from potential damage.
 - Easy to operate with enlarged thumb access.
- Positive Lock Latch is self-locking when hook is loaded.
- Eye style is designed with engineered flat to connect to S-1325 chain coupler.
- Suitable for use with Grade 100 and Grade 80 chain.
- The SHUR-LOC® hook, if properly installed and locked, can be used for personnel lifting applications and meets the intent of OSHA Rule 1926.1431(g)(1)(i)(A) and 1926.1501(g)(4)(iv)(B).
- Fatigue rated to 20,000 cycles at 1-1/2 times the Working Load Limit.

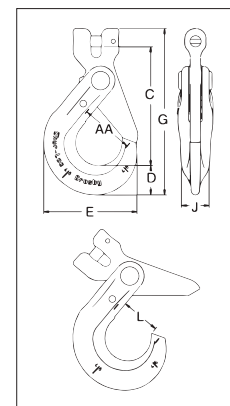

APPLICATION AND WARNING INFORMATION SECTION 17

S-1317 Clevis Hook

Chain Size		Working Load Limit (t)	Stock No.	Weight Each (kg)	Dimensions (mm)						
(in)	(mm)				C	D	E	G	J	L	AA
-	6	1.5	1028991	.35	87.4	20.1	66.0	121	16.0	29.0	38.1
1/4	7	2.0	1029000	.82	114	27.9	89.0	159	20.6	35.1	51.0
5/16	8	2.6	1029009	.82	114	27.9	89.0	159	20.6	35.1	51.0
3/8	10	4.0	1029018	1.66	140	29.7	112	192	24.1	46.5	63.5
1/2	13	6.8	1029027	3.08	173	42.4	139	242	29.5	56.4	76.2
5/8	16	10.3	1029036	5.40	209	51.8	167	295	38.1	67.3	89.0
3/4	18-20	16.0	1029071	6.80	239	56.4	197	336	51.6	89.4	-
7/8	22	20.0	1029080	12.7	283	62.2	222	392	55.9	97.3	-
1	26	27.1	1029089	22.5	319	81.5	251	468	68.1	104	-

4:1 Design Factor.





S-1325A



- Forged alloy steel — Quenched & Tempered.
- Designed to connect Grade 100 chain fittings produced with engineered flat to Grade 100 chain.
- Suitable for use with Grade 100 and Grade 80 chain.
- Individually Proof Tested to 2-1/2 times the Working Load Limit with certification.
- Locking system that provides for simple assembly and disassembly – no special tools required.
- Fatigue rated to 20,000 cycles at 1-1/2 times the Working Load Limit.

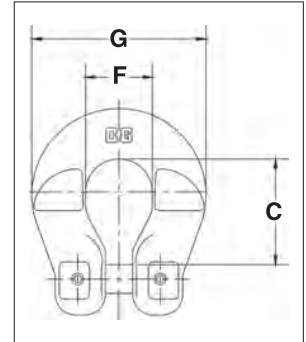

S-1325A Grade 100 Chain Coupler

Chain Size		Stock No.	Working Load Limit (t)	Weight Each (kg)	Dimensions (mm)		
(in)	(mm)				C	F	G
-	6	1098496	1.5	.11	26.2	19.3	44.7
1/4	7	1098500	2	.23	35.8	22.4	59.0
5/16	8	1098504	2.5	.23	35.6	22.4	59.0
3/8	10	1098508	4	.34	46.7	30.0	69.0
1/2	13	1098512	6.8	.75	55.6	38.1	94.5
5/8	16	1098516	10.3	.86	71.4	49.8	112

4:1 Design Factor.

S-1311N



- Forged alloy steel - Quenched & Tempered.
- Individually Proof Tested to 2-1/2 times the Working Load Limit with certification.
- Suitable for use with Grade 100 and Grade 80 chain.
- Spring loaded chain locking system keeps chain in place under slack conditions.
- The use of S-1311N Chain Shortener will allow 100 percent of the chain sling capacity.
- Fatigue rated to 20,000 cycles at 1-1/2 times the Working Load Limit.

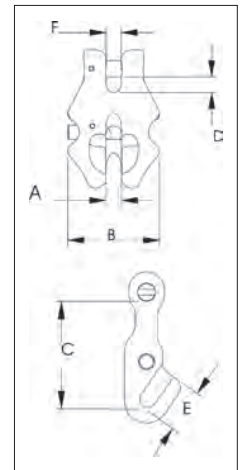

S-1311N Grade 100 Chain Shortener Link

Chain Size		Stock No.	Working Load Limit (t)	Weight Each (kg)	Dimensions (mm)					
(in)	(mm)				A	B	C	D	E	F
-	6	1017860	1.5	.34	7.61	44.7	46.5	7.37	19.3	7.37
1/4	7	1017869	2.0	.45	8.64	51.8	55.1	8.64	22.4	8.38
5/16	8	1017878	2.6	.45	10.2	59.9	64.3	9.91	25.7	9.65
3/8	10	1017897	4.0	.68	12.2	72.1	78.0	12.2	31.2	11.7
1/2	13	1017906	6.8	1.47	15.7	90.4	95.8	15.5	39.9	15.0
5/8	16	1017915	10.3	2.54	18.5	108	118	18.5	48.5	17.8

4:1 Design Factor.

CHAIN & ACCESSORIES



CHAIN & ACCESSORIES

A-1355



- Forged alloy steel - Quenched & Tempered.
- Individually Proof Tested with certification.
- Rated for Grade 100 chain in choker applications.
- Each hook has a Product Identification Code (PIC) for material traceability,
- along with the size and the name Crosby.
- Fatigue rated at 1-1/2 times the Working Load Limit at 20,000 cycles.
- For use with S-1325 Chain Coupler Link.

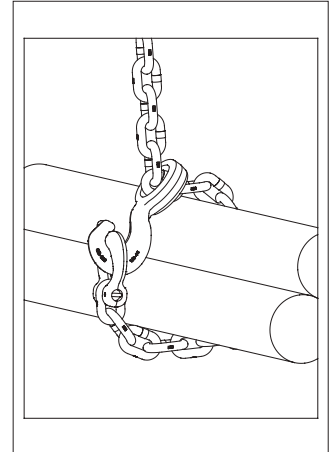

Crosby 8/10™ Fatigue Tested QT

6

A-1355 Chain Choker Hook

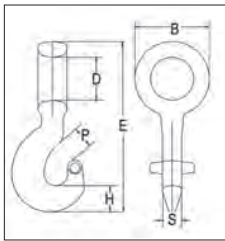

Grade 10 Alloy Chain Size		Working Load Limit (t)	Stock No.	Weight Each (kg)	Dimensions (mm)					
(in)	(mm)				B	D	E	H	P	S
1/4-5/16	7-8	2.6	1015204	.34	52.1	30.0	123	20.1	17.5	16.5
3/8	10	4.0	1015213	.74	67.6	39.9	154	23.6	23.6	17.5
1/2	13	6.8	1015222	1.42	85.1	51.6	193	30.0	32.0	23.8
5/8	16	10.3	1015231	3.16	107	64.0	246	39.1	28.4	30.0

4:1 Design Factor.

A-336



- Forged alloy steel - Quenched & Tempered.
- Individually Proof Tested at 2-1/2 times the Working Load Limit with certification.
- The Working Load Limit of the A-336 is less than Grade 80 chain ratings. When using in Grade 80 chain slings, ASME B30.9c requires that the Working Load Limit of a sling must not exceed the lowest Working Load Limit of the components in the system.

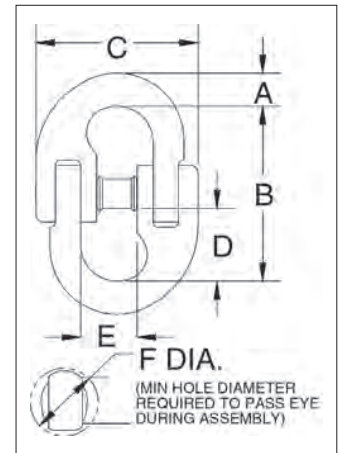

APPLICATION AND WARNING INFORMATION SECTION 17

A-336 LOK-A-LOY® 6 Connecting Link

Chain Size (mm)	Stock No.	Working Load Limit (t)	Weight Each (kg)	Dimensions (mm)					Diameter of Hole to Accept Link (mm)
				A	B	C	D	E	
6-7	1014397	1.47	.11	7.85	52.5	42.9	19.8	19.8	12.7
8-10	1014413	3.00	.27	11.4	69.0	58.5	26.9	27.7	16.8
13	1014431	5.10	.54	14.7	85.0	80.5	32.5	35.8	22.4
16	1014459	7.48	1.10	19.8	99.5	100	39.6	42.9	26.9
19	1014477	10.45	1.76	22.6	123	113	50.0	51.0	30.2
22	1014495	13.04	2.75	25.4	148	135	60.5	64.0	35.1
26	1014510	17.58	3.19	27.4	165	154	72.0	65.0	37.3
32	1014538	26.00	6.00	35.1	215	194	96.0	96.0	44.0

4:1 Design Factor.





CHAIN & ACCESSORIES

S-314A



- Forged alloy steel - Quenched & Tempered.
- Individually Proof Tested at 2-1/2 times the Working Load Limit with certification.
- Integrated heavy duty latch.
- Meets ASTM A-952 for Grade 80 chain fittings.
- Fatigue rated to 20,000 cycles at 1-1/2 times the Working Load Limit.

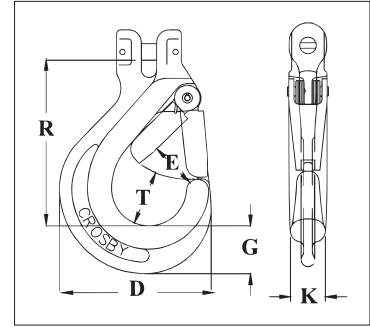

S-314A Clevis Chain Hook with Integrated Latch

Chain Size		Stock No.	Grade 8 Alloy Chain Working Load Limit (t)	Weight Each (kg)	Dimensions (mm)						Replacement Latch Stock No.
(in)	(mm)				D	E	G	K	R	T	
-	6	1225020	1.12	.32	66.0	20.6	20.0	16.0	72.3	26.0	1291332
1/4 - 5/16	7 - 8	1225021	2	.70	89.0	27.4	28.0	20.5	98.0	32.6	1291402
3/8	10	1225091	3.15	1.29	110.5	36.1	29.3	24.0	125.3	42.2	1291472
1/2	13	1225161	5.3	2.34	138.5	38.6	42.1	29.5	144.5	49.2	1291542
5/8	16	1225162	8	3.67	166.5	48.5	52.0	38.0	172.6	58.9	1291612

4:1 Design Factor.

S-315A



- Forged alloy steel - Quenched & Tempered.
- Individually Proof Tested at 2-1/2 times the Working Load Limit with certification.
- Crosby recommends grinding the WLL (which is 5:1 Design Factor) off the hook when using with Grade 80 chain.
- Integrated heavy duty latch.
- Engineered flat for use with S-1325A Coupler Link.
- Meets ASTM A-952 for Grade 80 chain fittings.
- Fatigue rated to 20,000 cycles at 1-1/2 times the Working Load Limit.

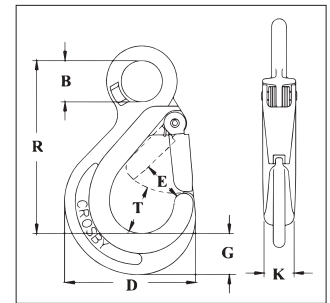

S-315A Eye Chain Hook with Integrated Latch

Chain Size		Stock No.	Grade 8 Alloy Chain Working Load Limit (t)	Working Load Limit for Wire Rope (short Tons)	Weight Each (kg)	Dimensions (mm)							Replacement Latch Stock No.
(in)	(mm)					B	D	E	G	K	R	T	
-	6	1029820	1.12	1	.25	20.1	66.0	20.6	20.1	16.0	84.5	25.9	1291332
1/4 - 5/16	7 - 8	1029825	2	2	.59	27.9	89.0	27.4	27.9	20.6	117	32.5	1291402
3/8	10	1029830	3.15	3	1.18	36.1	110	36.1	29.5	23.9	157	42.2	1291472
1/2	13	1029835	5.3	5	2.13	46.0	138	38.6	42.4	29.5	186	49.3	1291542
5/8	16	1029840	8	7	3.88	56.0	167	48.5	52.0	38.1	227	59.0	1291612

4:1 Design Factor for Grade 80 Alloy Chain, 5:1 Design Factor for wire rope.

G-334



- Forged steel - Quenched & Tempered.
- Has larger inside dimensions making it easier to attach hooks or other fittings to the chain.
- An exclusive Crosby product.
- After making connections, rivets must be peened.
- Not suitable for use with Grade 80 or Grade 100 chain and chain slings used in overhead lifting.

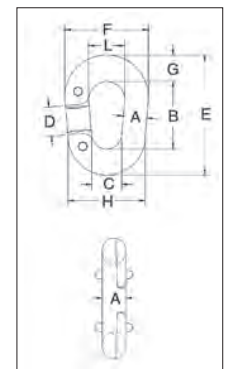

G-334 Pear Shape "Missing Link"® Replacement Links

Chain Size (mm)	Stock No.	Working Load Limit (t)	Weight Per 100 (kg)	Dimensions (mm)								
				A	B	C	D	E	F	G	H	L
10	1013432	.84	11.3	10.4	51.0	14.2	20.6	74.5	41.4	11.9	35.1	20.6
13	1013450	1.50	22.7	12.7	63.5	17.5	25.4	92.0	51.0	14.2	42.9	25.4
16	1013478	2.27	34.0	16.0	70.0	20.6	26.9	102	60.5	16.0	52.5	28.7
19	1013496	3.22	56.7	19.1	79.5	25.4	28.7	121	70.0	20.6	63.5	31.8
22	1013511	4.35	90.7	22.4	93.5	31.8	35.1	141	82.5	23.9	76.0	38.1

4:1 Design Factor.



CHAIN & ACCESSORIES

G-335



- Forged steel - Quenched & Tempered.
- Integral rivets join the two halves.
- After making connections, rivets must be peened.
- All sizes have countersunk rivet holes.
- Meets or exceeds the performance requirements of Federal Specifications RR-C-27IG, Type II, except for those provisions required of the contractor.
- Not suitable for use with Grade 80 or Grade 100 chain and chain slings used in overhead lifting.

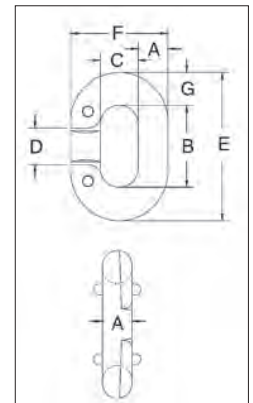

G-335 "Missing Link"® Replacement Links



Chain Size (in)	Stock No.	Working Load Limit (t)	Links Per Box	Weight Per 100 (kg)	Dimensions (mm)						
					A	B	C	D	E	F	G
*7	1013110	.60	10	2.83	7.10	22.4	11.2	11.2	38.1	25.4	7.85
*8	1013138	.89	10	5.67	8.65	23.9	11.9	11.9	42.9	29.5	9.65
10	1013156	1.25	10	9.07	10.4	28.7	14.2	14.2	52.5	35.1	11.9
11	1013174	1.65	10	12.5	11.9	32.5	15.0	15.0	59.5	38.9	13.5
13	1013192	2.15	10	17.0	13.5	37.3	16.8	16.8	67.5	43.7	15.0
16	1013236	3.30	10	32.9	16.8	46.0	19.8	20.6	84.0	53.0	19.1
19	1013254	4.65	10	55.5	19.8	54.0	23.9	26.9	98.5	63.5	22.4
22	1013272	5.45	Bulk	79.5	23.1	63.5	28.7	28.7	114	74.5	25.4
† 26	1013290	7.00	Bulk	113	26.2	70.0	31.8	31.8	127	84.0	28.7

4:1 Design Factor. *Rivets Only - No interlocking lugs. †Has reinforced rivet holes.

6

SLING IDENTIFICATION TAG KITS



Stamped ID Tags

- Stamped ID Tags
- Octagonal metal sling tag.
- Pre-stamped - easy to add sling length, Working Load
- Limit, name, etc.
- Front side is shown - reverse is blank.
- Available with or without welded attached ring.
- Attaching ring size is 5mm x 50mm.
- Available completely blank for wire rope sling applications.
- Gold painted.

ID Tag Stock No.	Carton Qty.	Weight Per Carton (kg)
115244	50	10.55

ID Tags

- Heavy Duty tags.
- 33 mm diameter ring opening (will fit 6mm - 16mm A-1337).
- Chain tags meet requirements of ASME B30.9 for Sling Identification.
- Raised edge and recessed pads to protect lettering.
- Raised lettering for quick reference.

Operating Frequency: 13.5MHz

Stock No.	Style	Material Type	RFID Equipped	Tag Size (mm)	Weight Each (kg)
115369	Chain	Cast Stainless Steel	Yes	160 x 42	.21
115350	Wire Rope	Cast Stainless Steel	Yes	43 x 33.3	.03
115217	Chain	Forged Steel	No	146 x 48	.18
115353	Chain	Stamped Zinc Plated Steel	Yes	5-3/4 x 1-5/8	.29
115355	Wire Rope	Stamped Zinc Plated Steel	Yes	1-11/16 x 1-5/16	.04
1224692	Zip Tie	High Crystalline Polyamide	Yes	193.675	1.4